

PushButtonFireplaces

intelligent fire



© PLANIKA | Ver. 24072017

PrimeFire Logs in casing

PrimeFire Logs

PrimeFire Logs in casing

*An automatic bio fireplace decorated with eco logs
Innovative technology that makes fire exceptional*



FEATURES:

- Natural flames with decorative logs and vermiculite
- BEV* Technology
- No smell / no ash / no smoke
- Optional remote control
- Advanced safety sensors
- Automatic shutdown in case of errors
- Child Lock
- Advanced microprocessor
- Diode display
- Intuitive control
- 2 levels of flame height
- Easy installation
- No additional installation
- No additional ventilation required
- No chimney required
- For indoor use
- Eco-friendly
- Advanced microprocessor
- Automatic refueling system



DIMENSIONS:

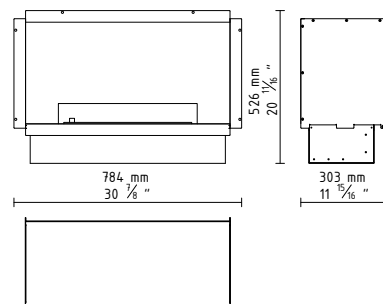

* BEV Technology – A patented process resulting in the clean burning of bio-ethanol fuel vapours.

TECHNICAL DATA:

Capacity: 2,5 L / [US] 0,65 gal / [UK] 0,55 gal

Burning time: 4,5-7h

Heat output: 2-3,1 kw / 6690 - 10512 BTU/h

Net weight: 48 kg / 106 lbs

Air circulation: min. 1/h

Minimum room size:

please contact our Project Department for details

Power supply: 230 V / 115 V

Finish:

TOP: black powder coated steel.

CASING: black powder coated steel

INDOOR INSTALLATION REQUIREMENTS:

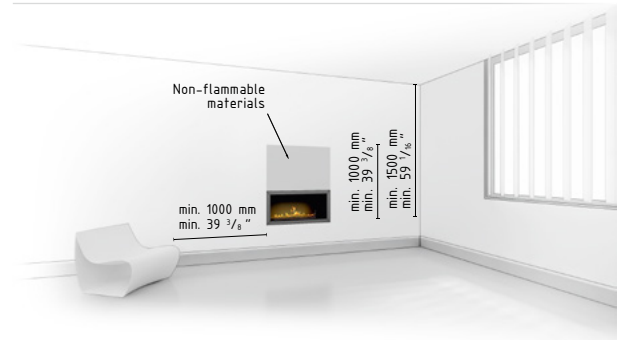

INSTALLATION:

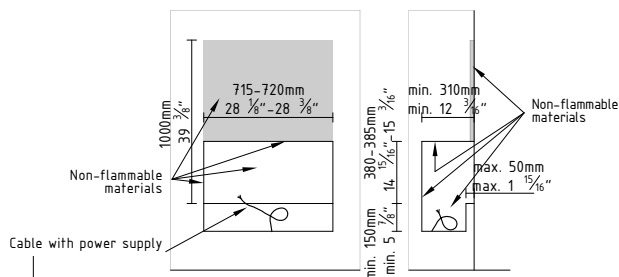

www.PLANIKAFires.com

download PRODUCT INSTRUCTION

